

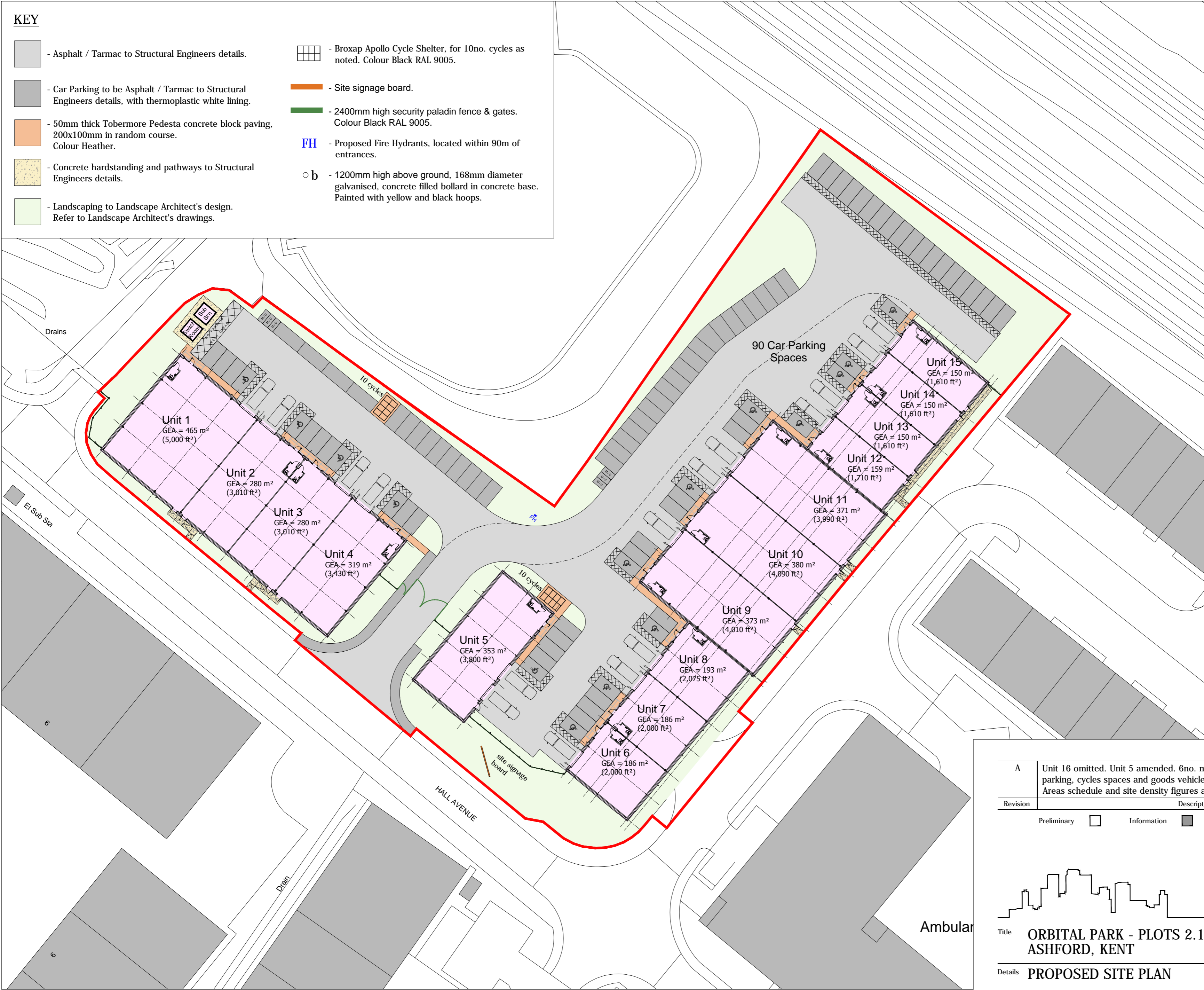

- Contractors must check all dimensions on site. Only figured dimensions are to be worked from. Discrepancies must be reported to the Architect or Engineer before proceeding. © This drawing is copyright
- Reproduced from OS Sitemap® by permission of Ordnance Survey® on behalf of The Controller of Her Majesty's Stationery Office. © Crown copyright 2008. All rights reserved. Licence number 100007126.

KEY

- Asphalt / Tarmac to Structural Engineers details.
- Car Parking to be Asphalt / Tarmac to Structural Engineers details, with thermoplastic white lining.
- 50mm thick Tobermore Pedesta concrete block paving, 200x100mm in random course. Colour Heather.
- Concrete hardstanding and pathways to Structural Engineers details.
- Landscaping to Landscape Architect's design. Refer to Landscape Architect's drawings.
- Broxap Apollo Cycle Shelter, for 10no. cycles as noted. Colour Black RAL 9005.
- Site signage board.
- 2400mm high security paladin fence & gates. Colour Black RAL 9005.
- Proposed Fire Hydrants, located within 90m of entrances.
- 1200mm high above ground, 168mm diameter galvanised, concrete filled bollard in concrete base. Painted with yellow and black hoops.



AREA SCHEDULE		
UNIT NUMBER	GEA (M ²)	GEA (FT ²)
UNIT 1	465	5000
UNIT 2	280	3010
UNIT 3	280	3010
UNIT 4	319	3430
UNIT 5	353	3800
UNIT 6	186	2000
UNIT 7	186	2000
UNIT 8	193	2075
UNIT 9	373	4010
UNIT 10	380	4090
UNIT 11	371	3990
UNIT 12	159	1710
UNIT 13	150	1610
UNIT 14	150	1610
UNIT 15	150	1610
TOTAL	3995	42955

SITE AREA

11,038 m² (118,810 ft²)
 1.1038 Hectares
 2.727 Acres

ACTUAL SITE DENSITY

PLOT DEVELOPMENT RATIO - 36.15% (42,955 ft²)
 LANDSCAPING - 20.57% (24,440 ft²)

PARKING PROVISION

- 90 Car parking spaces (of which 15 are disabled spaces)
- 16 Goods Vehicle parking spaces
- 20 Covered Cycle spaces

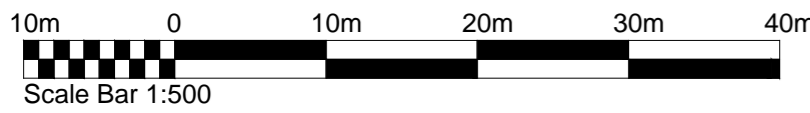
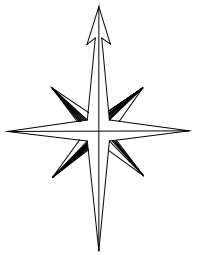

A	Unit 16 omitted. Unit 5 amended. 6no. motorcycle spaces added. Car parking, cycles spaces and goods vehicle spaces amended. Areas schedule and site density figures amended.	DMC	CHW	05.02.19	
Revision	Description	Drawn	Checked	Date	
	Preliminary <input type="checkbox"/>	Information <input checked="" type="checkbox"/>	Tender <input type="checkbox"/>	Construction <input type="checkbox"/>	As Built <input type="checkbox"/>



Woods Hardwick
 Architects, Engineers and Development Consultants

Title **ORBITAL PARK - PLOTS 2.1 & 2.3**
ASHFORD, KENT

Details **PROPOSED SITE PLAN**

15-17 Goldington Road
 Bedford
 MK40 3NH
 United Kingdom
 T. +44 (0)1234 268862
 F. +44 (0)1234 353034
 mail@woodshardwick.com
 www.woodshardwick.com

Scale **1:500 @ A2** Date **NOV 2018** Drawn **DMC** Chk **CHW**

18231-005-A

Please consider the environment before printing this drawing